

VIP lounges

Many airports have offices in the rest area and first class and business class passengers, and we have a variety of different access control systems to manage these areas. Evolves quick access door can be used for "non-contact" import and export management control, passengers even carry backpacks and luggage can also be fast and comfortable passage, the door can be automatically opened to allow authorized persons or passengers through, do not need to contact with the door.

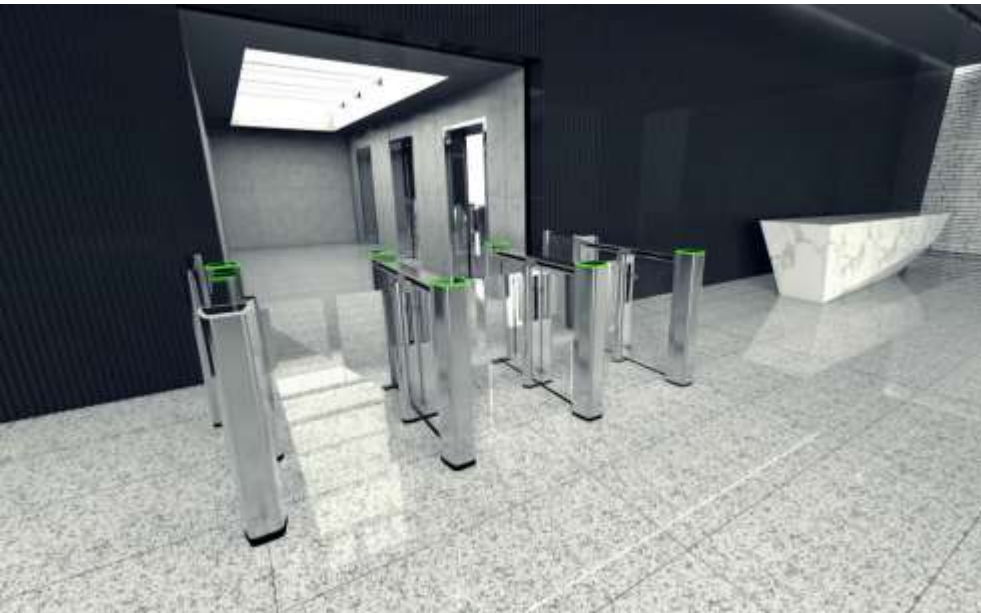

Evolves half-height turnstiles are also a good alternative for the entrance to VIP lounges. The integrated power assisted drive allows for easy access

- Simple and generous design.
- And the use of fast-track, for the disabled to provide a comfortable passage.

